

| Room | Size | Sq. Ft. | Ceiling | Theatre | Classroom | Conference | Banquet | Reception | Level |
|-----------------------------|----------|-------------|-----------------|---------|-----------|------------|-----------|--------------------------|---------|
| Emerald Ballroom | | | | | | | | | |
| Total | 66'x144' | 9504 sq.ft. | 16' | 1055 | 655 | 325 | 750 | 1500 | Lobby |
| Section A | 33'x36' | 1188 sq.ft. | 16' | 135 | 60 | 40 | 90 | 180 | Lobby |
| Section B | 33'x36' | 1188 sq.ft. | 16' | 135 | 60 | 40 | 90 | 180 | Lobby |
| Section C | 66'x36' | 2376 sq.ft. | 16' | 265 | 150 | 70 | 180 | 250 | Lobby |
| Section D | 66'x36' | 2376 sq.ft. | 16' | 265 | 150 | 70 | 180 | 250 | Lobby |
| Section E | 66'x36' | 2376 sq.ft. | 16' | 265 | 150 | 70 | 180 | 250 | Lobby |
| Foyer | | 8762 sq.ft. | - | - | - | - | - | 840 | Lobby |
| Coral Ballroom | | | | | | | | | |
| Total | 112'x50' | 5600 sq.ft. | 14' | 700 | 385 | 255 | 550 | 700 | Lobby |
| Section A | 40'x50' | 2000 sq.ft. | 14' | 250 | 140 | 90 | 160 | 150 | Lobby |
| Section B | 24'x50' | 1200 sq.ft. | 14' | 140 | 75 | 55 | 90 | 90 | Lobby |
| Section C | 24'x50' | 1200 sq.ft. | 14' | 140 | 75 | 55 | 90 | 90 | Lobby |
| Section D | 24'x50' | 1200 sq.ft. | 14' | 140 | 75 | 55 | 90 | 90 | Lobby |
| Foyer | - | 8762 sq.ft. | - | - | - | - | - | 550 | Lobby |
| Sandpiper | | | | | | | | | |
| Total | 127'x32' | 4064 sq.ft. | 9' | 380 | 200 | - | 300 | 450 | Theatre |
| Section A | 28'x32' | 896 sq.ft. | 9' | 50 | 35 | 20 | 40 | 75 | Theatre |
| Section B | 28'x32' | 896 sq.ft. | 9' | 50 | 35 | 20 | 40 | 75 | Theatre |
| Section C | 28'x32' | 896 sq.ft. | 9' | 50 | 35 | 20 | 40 | 75 | Theatre |
| Section D | 43'x32' | 1376 sq.ft. | 9' | 150 | 75 | 40 | 90 | 125 | Theatre |
| Foyer | - | - | - | - | - | - | - | 300 | Theatre |
| Boardroom | 30'x17' | 510 sq.ft. | 9' | 55 | 35 | 22 | 40 | 60 | Lobby |
| Theatre | 35'x36' | 1260 sq.ft. | 10' | 106 | 106 | - | - | - | Theatre |
| Pelican | 41'x22' | 902 sq.ft. | 9' | 100 | 60 | 40 | 80 | 80 | Theatre |
| Heron | 35'x24' | 840 sq.ft. | 9' | 90 | 60 | 38 | 60 | 80 | Theatre |
| Dolphin | 50'x16' | 800 sq.ft. | 14' | 80 | 50 | 30 | 60 | 80 | Theatre |
| Cobia* | - | 810 sq.ft. | - | - | - | 10 | 10 | 50 | - |
| Marlin* | - | 810 sq.ft. | - | - | - | 10 | 10 | 50 | - |
| West Pool South Side | - | 5000 sq.ft. | - | - | - | - | 400 | 600 | - |
| Wood Deck West | - | 2400 sq.ft. | - | - | - | - | 90 | 200 | - |
| Pool Courtyard | - | 2000 sq.ft. | - | - | - | - | 100 | 200 | - |
| Beach | - | Endless | Sky's the Limit | - | - | - | Any Style | Unlimited Accommodations | - |

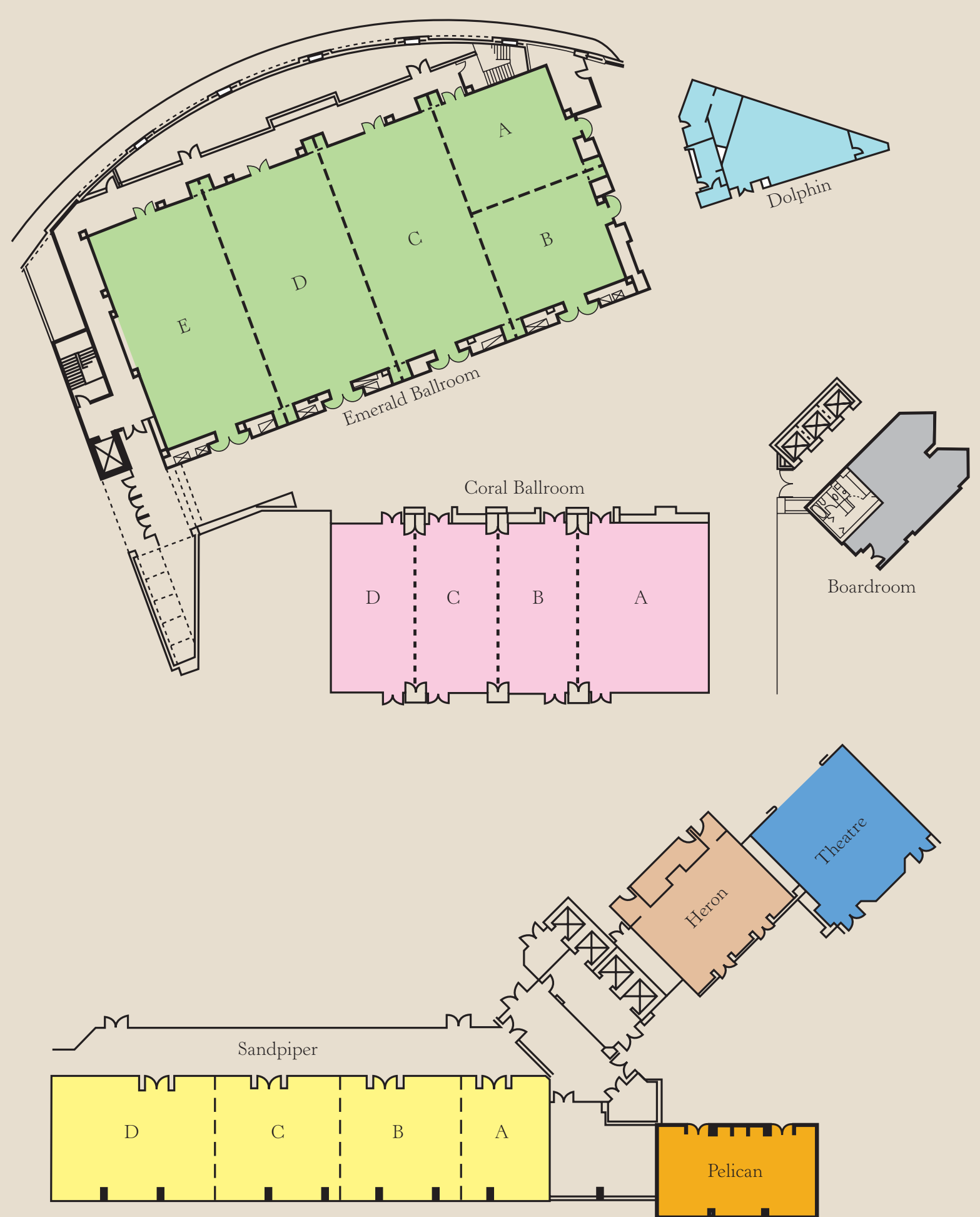

**Hilton Sandestin Beach
Golf Resort & Spa**

4000 Sandestin Boulevard South
Destin, Florida 32550
Sales & Event Planning Office: 850.267.9600 Fax: 850.267.1816
www.sandestinbeachhilton.com

*Cobia and Marlin include: Private bathroom facilities, refrigerator, wet bar area, TV/VCR, soft casual seating and private guest room keys for your convenience.